

WeatherTRAK ET Pro2 SWM to WeatherTRAK ET Pro3 Upgrade Installation Guide

Included in Guide:

- Installation Procedure
- Controller Activation

Questions? Contact Customer Support at
support@hydropoint.com or call (800) 362-8774

CONTENTS

CONTENTS	1
GETTING STARTED	1
OVERVIEW OF THE STEPS FOR UPGRADING FROM ET PRO 2 SWM TO ET PRO3	1
INCLUDED EQUIPMENT	1
EXISTING EQUIPMENT THAT WILL BE USED	2
TOOLS NEEDED	2
CENTRAL INTERNET MANAGEMENT SERVICE (CIM)	2
GETTING STARTED WITH THE UPGRADE	2
UPGRADE INSTRUCTIONS.....	3
STEP 1 - REMOVE THE COMMAND MODULE AND DISCONNECT THE POWER	3
STEP 2 - DISCONNECT THE POWER CABLE FROM THE MINI-CHASSIS	3
STEP 3 - TRANSFER THE STATION KEYS	4
STEP 4 - DISCONNECT THE RAIN SENSOR	4
STEP 5 - LABEL AND DISCONNECT THE VALVE WIRES	4
STEP 6 - REMOVE THE WEATHERTRAK PRO2 SWM MINI-CHASSIS	5
STEP 7 - INSTALL THE NEW WEATHERTRAK ET PRO 3 MINI-CHASSIS	6
STEP 8 - RECONNECT THE VALVE WIRES AND RAIN SENSOR	7
STEP 9 - INSTALL THE WEATHERTRAK PRO3 COMMAND MODULE	7
STEP 10 - UPDATE THE DATE AND TIME	8
SETTING THE DATE.....	8
SETTING THE TIME AND TIME ZONE	8
ENABLING AUTOMATIC DAYLIGHT SAVINGS TIME	8
STEP 11 - ACTIVATE CONTROLLER WITH HYDROPOINT.....	9
STEP 12 – TESTING THE NEW WEATHERTRAK ET PRO3 CONTROLLER.....	9
VALVE TEST	9
CONTROLLER CONFIGURATION CHECK	10
CHECKLISTS	11
WEATHERTRAK ET PRO2 SWM CHECKLIST	11
WEATHERTRAK ET PRO3 CHECKLIST	11

Getting Started

Thank you for purchasing the WeatherTRAK ET Pro3 upgrade kit.

WeatherTRAK ET Pro3 is the industry's most powerful cloud-based outdoor water management controller, providing top of the line technology and innovation. The higher station count option, additional flow management and monitoring, and increased scheduling flexibility make upgrading from the older WeatherTRAK ET Pro2 SWM controller a good decision.

Overview of the Steps for Upgrading from ET Pro 2 SWM to ET Pro3

To upgrade your controller, you need to perform the following steps:

Step 1 - Remove the command module and disconnect the power.

Step 2 - Disconnect the antenna and ribbon cable.

Step 3 - Transfer the station keys from the Pro2 SWM to the Pro3.

Step 4 - Disconnect the rain sensor.

Step 5 - Label and disconnect the valve wires.

Step 6 - Remove the ET Pro2 SWM mini-chassis.

Step 7 - Install the ET Pro3 mini-chassis.

Step 8 - Reconnect the valve wires and rain sensor.

Step 9 - Install the ET Pro3 command module.

Step 10 - Update the date and time.

Step 11 - Activate controller with HydroPoint.

Step 12 - Test the new ET Pro3 Controller.

Included Equipment

- Pro3 command module
- Pro3 mini-chassis
- 3G modem
- Ribbon cable

Existing equipment that will be used

- Enclosure/pedestal
- Rain/freeze sensor (if applicable)
- Transformer
- Antenna
- Station keys

Tools Needed

- 7/16" nut driver
- Flatblade screwdriver
- Philips screwdriver
- Pen and notepad to record controller serial numbers and SIM numbers

Central Internet Management Service (CIM)

The upgrade requires an active CIM subscription service. The existing subscription will be transferred to the upgraded controller with the same end-of-service date. If you do not have an active subscription, contact HydroPoint Customer Support at 800.362.8774.

Getting Started with the Upgrade

Be sure to follow the step-by-step procedure when performing your upgrade. [Use the WeatherTRAK ET Pro2 SWM and WeatherTRAK ET Pro3 upgrade checklist](#) at the end of this document to ensure all steps are completed for the equipment and software transfer.

Upgrade Instructions

Step 1 - Remove the Command Module and Disconnect the Power

1. Loosen the 4 corner pop-up screws. Lift the command module then turn it over.
2. Carefully unplug the power cable from the mini-chassis.

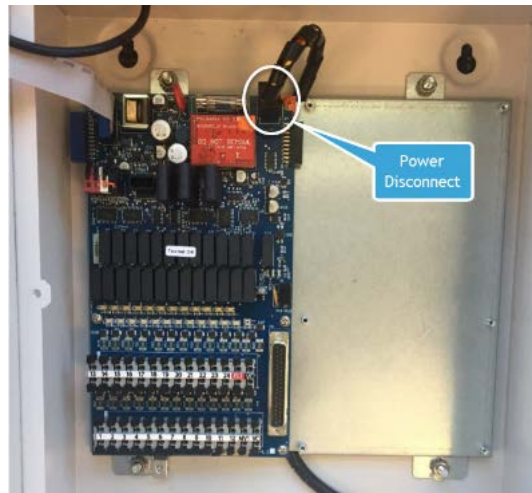

Step 2 - Disconnect the power cable from the mini-chassis

1. Disconnect the antenna cable from the back of the command module.
2. Disconnect the ribbon cable from the back of the command module.
3. Remove the command module and set aside.



Step 3 - Transfer the station keys

It is important to take the station keys from the ET Pro2 SWM and move them to the ET Pro3. The controller will not recognize the station valves unless the station keys have been transferred. A hardware alert will be received if this is not done.



1. Locate the station keys on the ET Pro2 SWM and remove them.
2. Plug the station keys from the ET Pro2 SWM into the ports on the ET Pro3 mini-chassis. The order is not important; however, it is important to start with the left-most port.

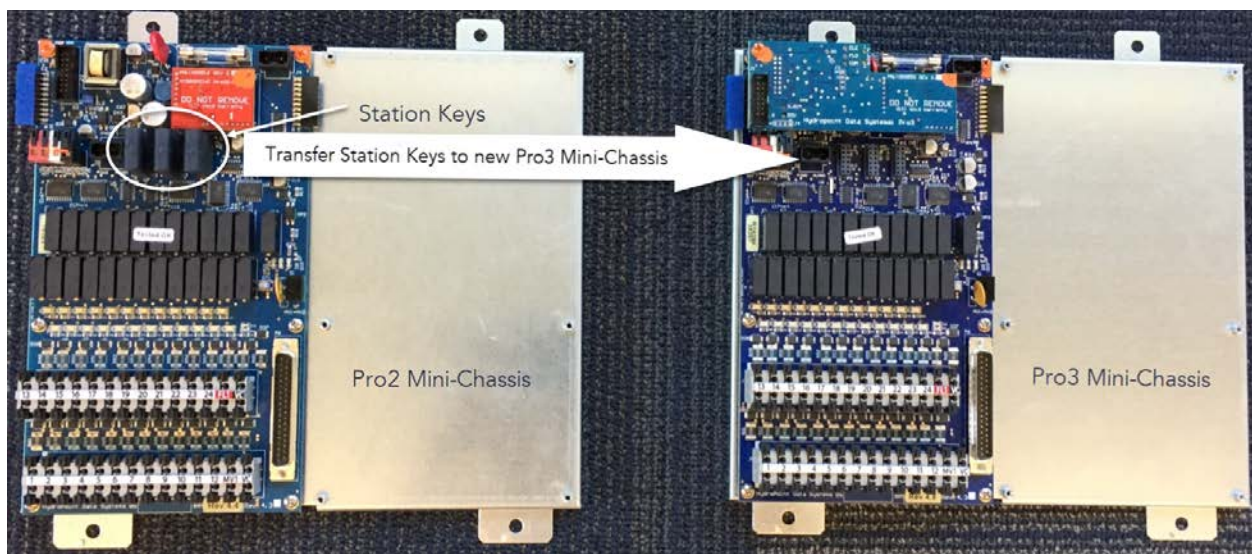

Step 4 - Disconnect the Rain Sensor

If a rain sensor is connected, disconnect it. You will be reconnecting the rain sensor to the new WeatherTRAK ET Pro3 mini-chassis in step 9.

Step 5 - Label and Disconnect the Valve Wires

1. If your valve wires are not labeled, you will need to label them. A wire-marker book or masking tape and a permanent marker work well for labeling.
2. Disconnect the valve wires from the mini-chassis board.

Step 6 - Remove the WeatherTRAK Pro2 SWM Mini-Chassis

1. Verify that the power cable has been unplugged from the mini-chassis board.
2. Remove the grounding wire.
3. Remove the grounding lug by unscrewing the nut that is holding it to the mounting bolt using the 7/16" nut driver.
4. Remove the nuts that are on the remaining mounting bolts using the 7/16" nut driver.
5. Set aside the grounding lug and nuts. You will be using them when installing the ET Pro3 mini-chassis.
6. Remove the mini-chassis board and set it aside.

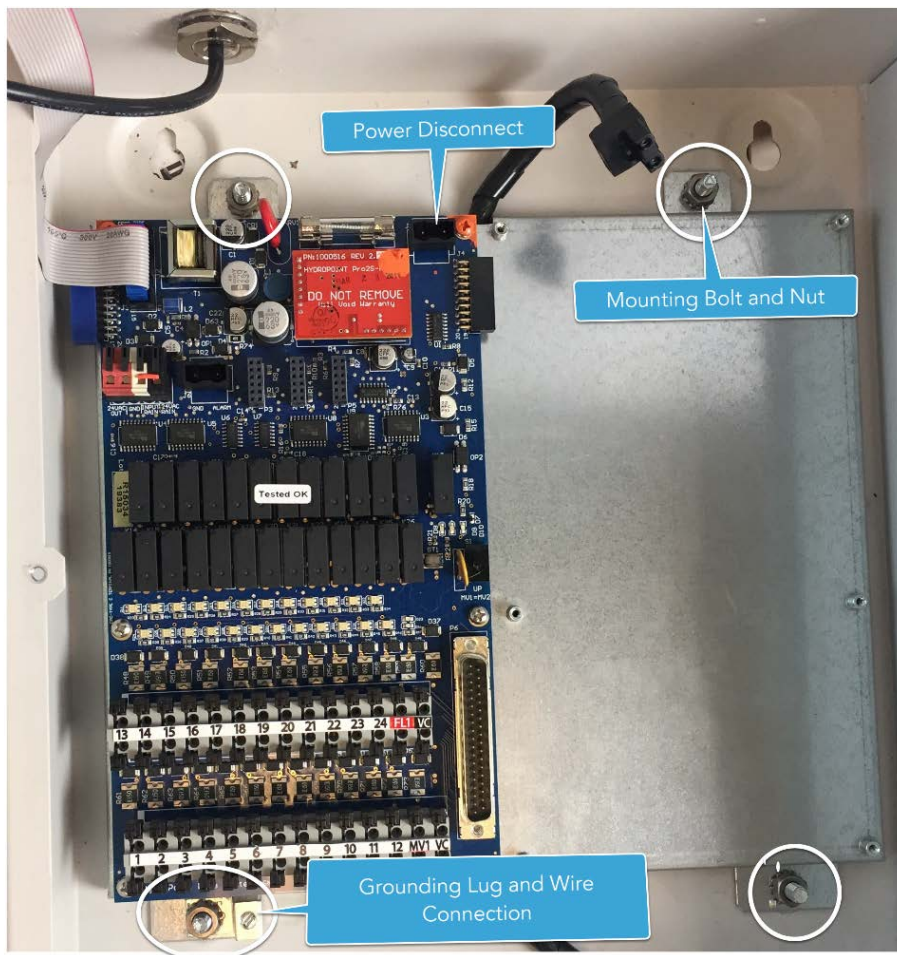

Step 7 - Install the New WeatherTRAK ET Pro 3 Mini-Chassis

1. Route the power connector behind the mini-chassis.
2. Align the new ET Pro3 mini-chassis board over the mounting bolts and make sure it is properly seated.
3. Position the grounding lug on one of the lower corners.
4. Tighten the nuts on the grounding lug and the remaining 3 nuts, using the 7/16" nut driver.
5. Connect the grounding wire to the grounding lug.

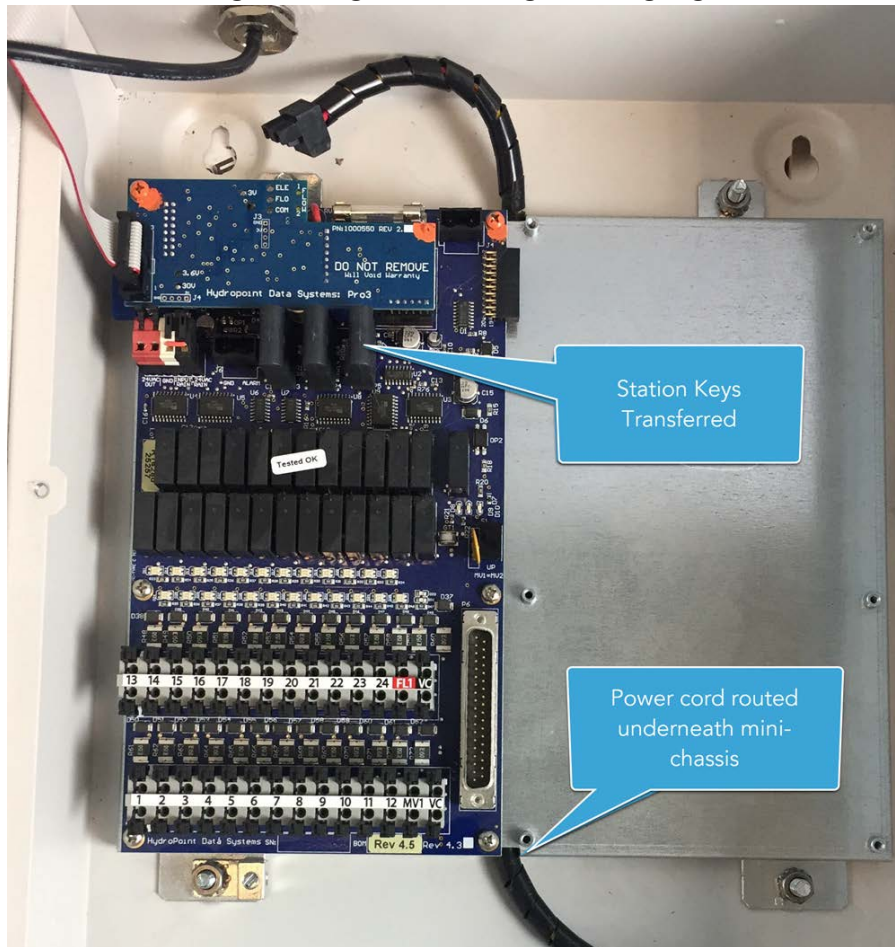

Step 8 - Reconnect the Valve Wires and Rain Sensor

1. Reconnect the valve wires to their appropriate outputs.
2. Reconnect the rain sensor if applicable.

Step 9 - Install the WeatherTRAK Pro3 Command Module

1. Connect the ribbon cable from the back of the command module to the mini-chassis.
2. Connect the antenna cable to the back of the command module.
3. Connect the power cord to the mini-chassis.

Note: Make sure the ribbon cable and the antenna are undamaged and properly connected.

4. Place the Pro3 command module over the 4 pre-drilled screw holes at the top of the cabinet.
5. Hand tighten the four corner screws. Be careful not to overtighten

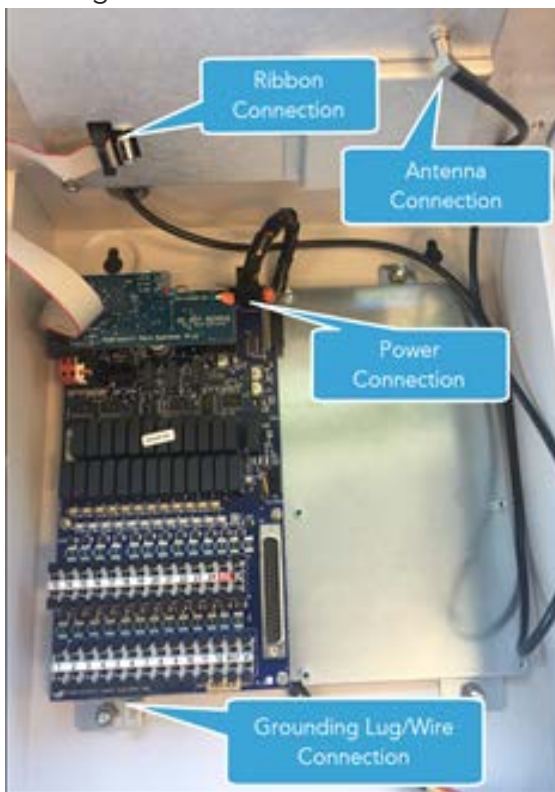

ET Pro 3 Mini-Chassis



ET Pro 3 Command Module

Step 10 - Update the Date and Time

Setting the Date

1. Press the **SETUP** button.
2. Press the → button. The **DATE (YEAR)** screen displays.
3. Press the + or – button to set the current year.
4. Press the → button. The **DATE (MONTH)** screen displays.
5. Press the + or – button to set the current month.
6. Press the → button. The **DATE (DAY)** screen displays.
7. Press the + or – button to set the current day.

Setting the Time and Time Zone

1. Press the **SETUP** button.
2. Press the → button until the **TIME (HOUR)** screen displays.
3. Press the + or – button to set the current hour.
4. Press the → button. The **TIME (MINUTE)** screen displays.
5. Press + or – to set the current minute.
6. Press the → button. The **TIME ZONE** screen displays.
7. Press + or – to set the desired time zone.

Enabling Automatic Daylight Savings Time

Your controller can be set to automatically adjust to daylight savings time.

1. Press the **SETUP** button.
2. Press the → button until the **AUTO DAYLIGHT SAVINGS** screen displays.
3. Perform one of the following options:
 - To set the controller to automatically adjust to daylight savings time, press + or - to select **Yes**.
 - To set the controller so it does NOT automatically adjust to daylight savings time, press + or – to select **No**.

Step 11 - Activate Controller with HydroPoint

Before calling Customer Service to activate the controller, you will need to know the serial number, SIM card number, and location of the controller. You can record this information on the checklist page at the end of this document.

1. Write down the serial number from BOTH controllers. The serial number can be found on a sticker attached to the front lower corner of the command module.
2. Write down the SIM number from the new controller. To find the SIM number:
 - Press the **HELP** button.
 - Press the → button until the **SIM CARD SERIAL NUMBER** screen displays.
3. Make note of the location of the controller.
4. Call customer service 1-800-362-8774 to activate. When calling, let the representative service tech know you are upgrading a controller and will be transferring data. When activating, all programming and report data will be transferred from the ET Pro2 SWM controller to the ET Pro3 controller.

Step 12 – Testing the new WeatherTRAK ET Pro3 Controller

After the controller has been activated, you will need to test the system to ensure that the new WeatherTRAK controller is operating properly. You will need to perform a valve test and a controller configuration check.

Valve Test

To ensure all field wiring is properly connected and all stations are operating properly, conduct a field wire integrity test.

1. Press the **MANUAL TEST** button.
2. Press the – button until the **Valve Test** screen displays.
3. Press the → button until the **RUN VALVE TEST** screen displays.
4. Press the **SELECT** button, then press the * button to start the test. It will take about 15 seconds to verify continuity to all stations and the master valve.

If any field wiring issues exist, they will be identified as a "Fault". A valve fault could be "SH" (valve short) from a failing solenoid, "OC " (over current) from valves drawing more than 1000 mA or "NC" (valve no-connect or open), reflecting a broken wire or wire that is not making good contact in the corresponding station terminal.

Controller Configuration Check

After installing the WeatherTRAK ET Pro3, you will need to check your controller configuration to make sure that all the stations are being read by the controller. To check configuration:

1. Press the **SETUP** button.
2. Press the * button. The following screen will display something similar:

SETUP: 01		02:15pm	
STA	CONFIG	FOUND	ACTIVE
	96	24	20

You want to check to see that the number of Found and Active stations matches the setting for Max Active stations. SETUP screen 01 is explained as follows:

Config: Set by WeatherTRAK at the time of manufacture. This is the number of stations that the controller is capable of managing.

Found: The number of station outputs enabled on the terminal board via the station keys. If the controller has been configured properly, this number should never be 0.

Active: The maximum number of user defined active station that will be programmed.

If you have any questions or need further assistance, you can contact us at 800.362.8774.

© Copyright 2018 HydroPoint Data Systems, Inc. All rights reserved. HydroPoint, WeatherTRAK, WaterCompass, and the HydroPoint logo are registered trademarks and FlowLink and OptiFlow are trademarks of HydroPoint Data Systems, Inc. Other trademarks may be held by their respective owners. Specifications, user interface, workflow, procedures, and content formats subject to change without notice.

Checklists

WeatherTRAK ET Pro2 SWM Checklist

- Record controller serial number:_____
- Label station wires and remove
- Remove station keys and set aside
- Disconnect the rain sensor (if applicable)
- Remove the WeatherTRAK ETPro2 SWM hardware parts that are being replaced: mini-chassis, command module, ribbon cable
- Dispose of WeatherTRAK ET Pro2 SWM parts in accordance with local E-waste laws

WeatherTRAK ET Pro3 Checklist

- Record controller serial number:_____
- Record SIM card number:_____
- Record location of controller:_____
- Install the WeatherTRAK ET Pro3 upgrade parts: mini-chassis, command module, ribbon cable
- Install station wires
- Transfer station keys from WeatherTRAK ETPro2 SWM to WeatherTRAK ET Pro3
- Update current date and time on controller
- Contact Customer Support at 800.362.8774 to activate the new WeatherTRAK ET Pro3 controller
- Run valve test and do a controller configuration check to ensure the system is working properly

WeatherTRAK[®]

www.hydropoint.com

1 (800) 362-8774 support@hydropoint.com



RevA20180215

